

the concepts, ideas, drawings and specifications herein are an original unpublished work and the property of WOW Ateller, LLC and shall not be used on any other work. do not scale drawings. all conditions shall be verified on site. discrepancies shall be brought to the attention of the architect before proceeding.
plot date:10/27/2017 1:07:53 PM

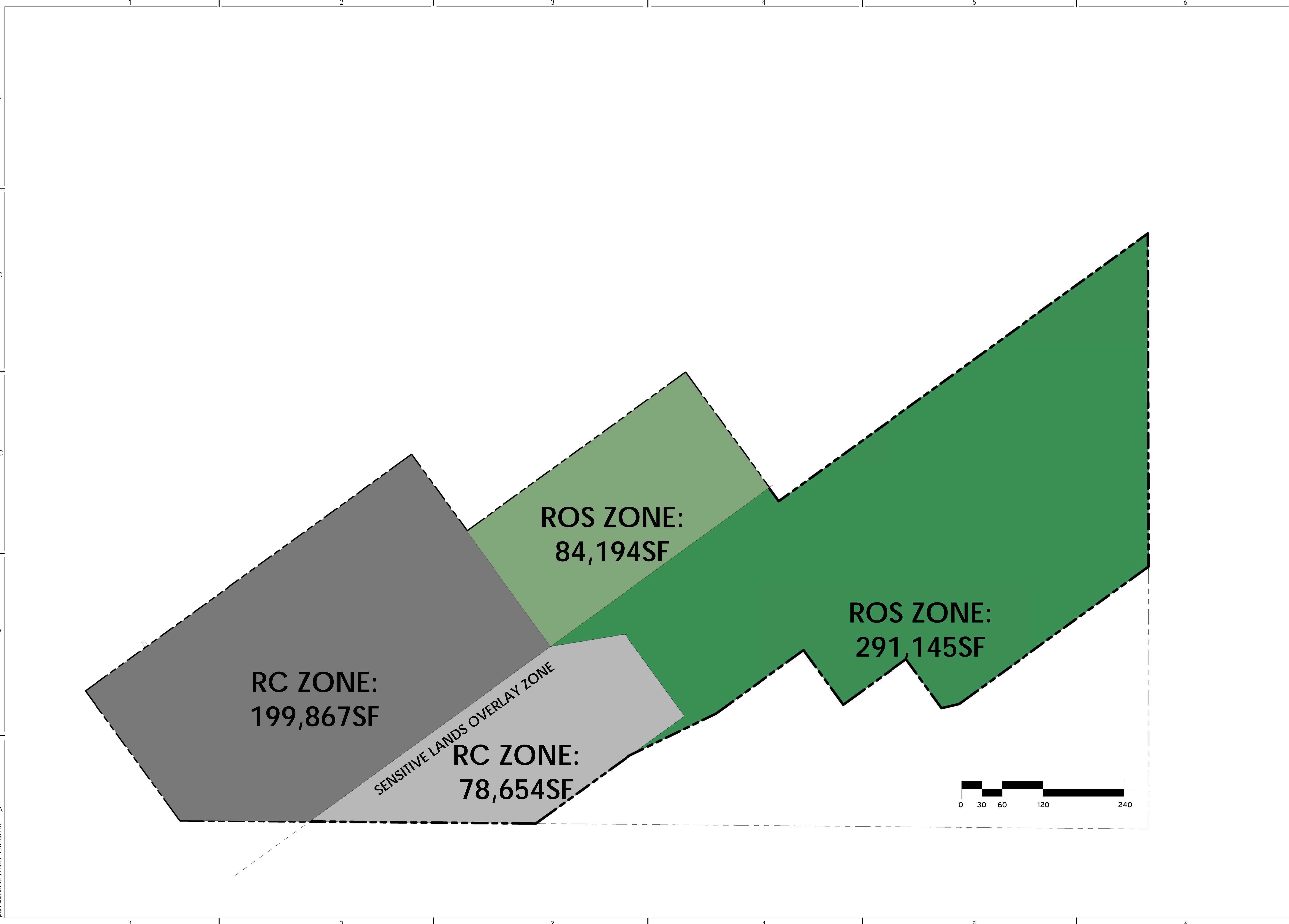

WOW

**PRELIMINARY
NOT FOR
PERMIT OR
CONSTRUCTION**

CIVIL: EVERGREEN
STRUCTURAL: JARRAIT ENGINEERING
MECHANICAL: PVE INC
ELECTRICAL: BNA CONSULTING
LANDSCAPE: LO/CI
INTERIOR: WOW +

KING'S CROWN
MASTER PLANNED DEVELOPMENT
1201-1299 LOWELL AVENUE
PARK CITY, UTAH

PROJECT #: 160026
ISSUE DATE: 10/27/2017
ISSUE: MPD SUBMITTAL REVISIONS

**PROPERTY ZONE AREA
PLAN**

AS-005

COPYRIGHT: WOW ateller, LLC. 2017

the concepts, ideas, drawings and specifications herein are an original unpublished work and the property of WOW Ateller, LLC and shall not be used on any other work. do not scale drawings. all conditions shall be verified on site. discrepancies shall be brought to the attention of the architect before proceeding.
plot date: 10/27/2017 1:07:58 PM

- Condos - 30,920 sf - 4.7%
- TownHomes - 10,930 sf - 1.7%
- Lot Building Pads - 35,584 sf - 5.4%
- Roads/ Sidewalks - 27,297 sf - 4.3%
- Open Hardscape - 17,012 sf - 2.6%
- Open Space - 531,519 sf - 81.3%

Total - 653,759 sf

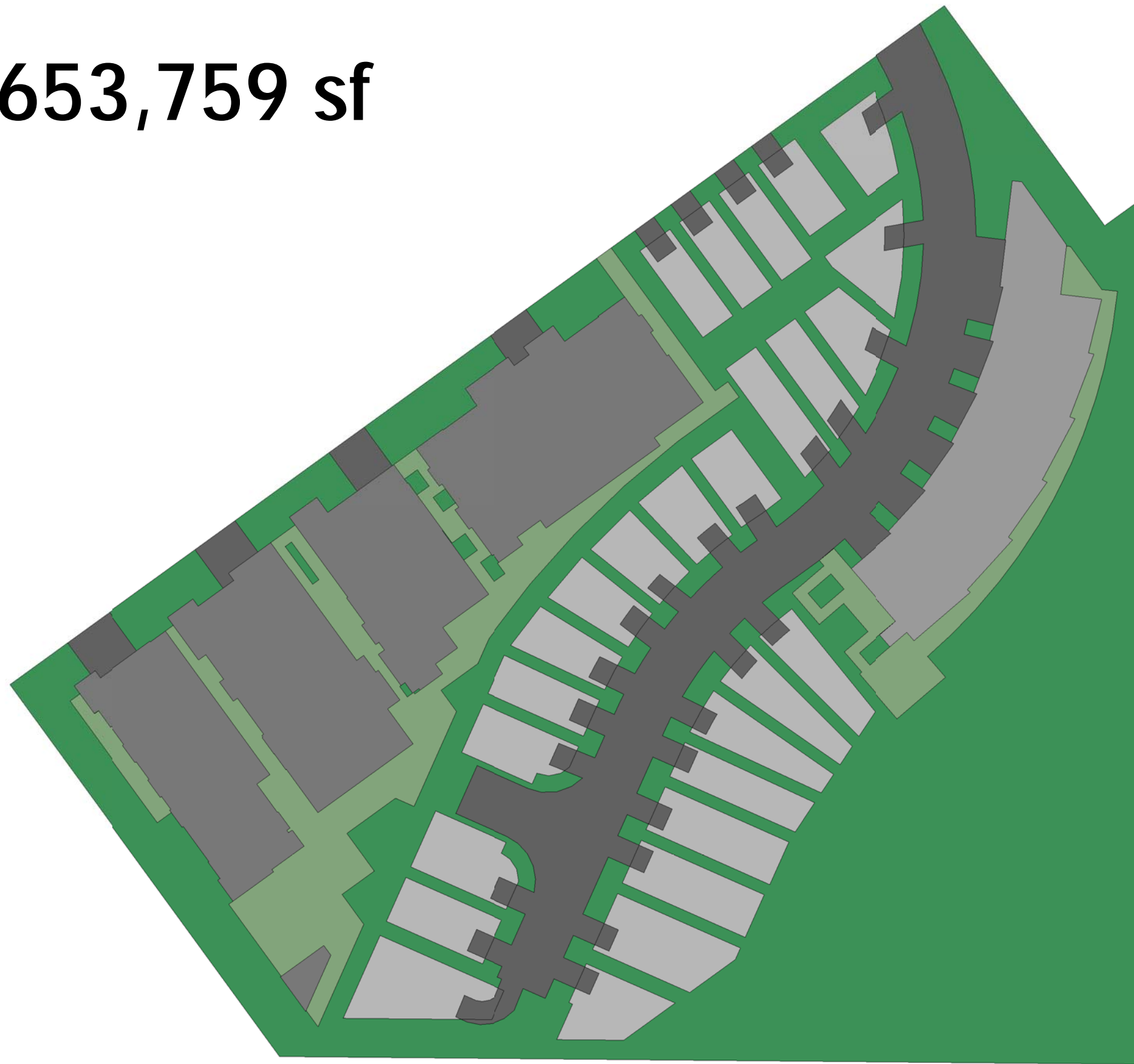
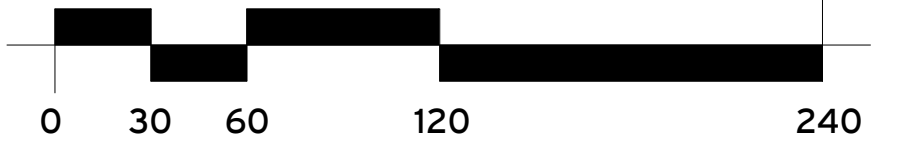

WOW

**PRELIMINARY
NOT FOR
PERMIT OR
CONSTRUCTION**

CIVIL: EVERGREEN
STRUCTURAL: JARRAIT ENGINEERING
MECHANICAL: PVE INC
ELECTRICAL: BNA CONSULTING
LANDSCAPE: LO/CI
INTERIOR: WOW +

KING'S CROWN
MASTER PLANNED DEVELOPMENT
1201-1299 LOWELL AVENUE
PARK CITY, UTAH

PROJECT #: 160026
ISSUE DATE: 10/27/2017
ISSUE: MPD SUBMITTAL REVISIONS

**OPEN SPACE
CALCULATIONS**
AS-006
COPYRIGHT: WOW ateller, LLC. 2017

the concepts, ideas, drawings and specifications herein are an original unpublished work and the property of WOW Ateller, LLC and shall not be used on any other work. do not scale drawings. all conditions shall be verified on site, discrepancies shall be brought to the attention of the architect before proceeding.
 plot date: 10/27/2017 1:08:05 PM



Residential Lot Areas, Pads and Approximate Maximum Areas

Lot Number	Lot Area	Max Bldg Pad	Max Footprint	Approx Buildable SF
Lot 3	1,875	1,045	844	2,025
Lot 4	1,875	1,045	844	2,109
Lot 5	1,875	1,045	844	2,109
Lot 6	1,875	945	844	2,109
Lot 7	2,445	1,168	1,066	2,664
Lot 8	3,017	1,490	1,273	3,183
Lot 9	2,005	1,102	896	2,239
Lot 10	2,327	1,303	1,021	2,552
Lot 11	2,182	1,275	965	2,413
Lot 12	2,012	1,121	898	2,246
Lot 13	2,049	1,141	913	2,283
Lot 14	2,042	1,140	910	2,276
Lot 15	2,017	1,131	900	2,251
Lot 16	1,996	1,123	892	2,230
Lot 17	1,992	1,129	891	2,226
Lot 18	2,691	1,348	1,157	2,892
Lot 19	3,009	1,581	1,270	3,176
Lot 20	2,270	1,332	999	2,498
Lot 21	5,777	2,203	2,088	5,220
Lot 22	3,253	1,390	1,355	3,387
Lot 23	3,350	1,992	1,388	3,469
Lot 24	2,820	1,656	1,203	3,008
Lot 25	2,820	1,656	1,203	3,008
Lot 26	2,356	1,314	1,032	2,580
Lot 27	2,370	1,335	1,037	2,593
Lot 28	2,342	1,313	1,027	2,567
Lot 29	2,343	1,306	1,027	2,567

WOW
 PRELIMINARY
 NOT FOR
 PERMIT OR
 CONSTRUCTION

CIVIL: EVERGREEN
 STRUCTURAL: JARRATT ENGINEERING
 MECHANICAL: PVE INC
 ELECTRICAL: BRN CONSULTING
 LANDSCAPE: LO/CI
 INTERIOR: WOW +

KING'S CROWN
 MASTER PLANNED DEVELOPMENT
 1201-1299 LOWELL AVENUE
 PARK CITY, UTAH

PROJECT #: 160026
 ISSUE DATE: 10/27/2017
 ISSUE: MPD SUBMITTAL REVISIONS

**BUILDING PADS/
 SETBACKS**
AS-007
 COPYRIGHT: WOW ateller, LLC. 2017

the concepts, ideas, drawings and specifications herein are an original unpublished work and the property of WOW Ateller, LLC and shall not be used on any other work, do not scale drawings, all conditions shall be verified on site, discrepancies shall be brought to the attention of the architect before proceeding.
plot date: 10/27/2017 1:08:47 PM

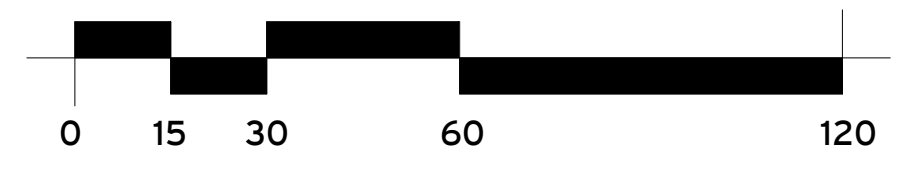

**SNOW STORAGE
DIAGRAM**

AS-008

COPYRIGHT: WOW ateller, LLC, 2017

PROJECT #:
160026
ISSUE DATE:
10/27/2017
ISSUE:
MPD SUBMITTAL
REVISIONS

KING'S CROWN
MASTER PLANNED DEVELOPMENT
1201-1299 LOWELL AVENUE
PARK CITY, UTAH

CIVIL:
EVERGREEN
STRUCTURAL:
JARRAIT ENGINEERING
MECHANICAL:
PVE INC
ELECTRICAL:
BNA CONSULTING
LANDSCAPE:
LO/CI
INTERIOR:
WOW +

**PRELIMINARY
NOT FOR
PERMIT OR
CONSTRUCTION**

WOW

the concepts, ideas, drawings and specifications herein are an original unpublished work and the property of WOW Ateller, LLC and shall not be used on any other work. do not scale drawings. all conditions shall be verified on site, discrepancies shall be brought to the attention of the architect before proceeding.
plot date: 10/27/2017 1:08:58 PM

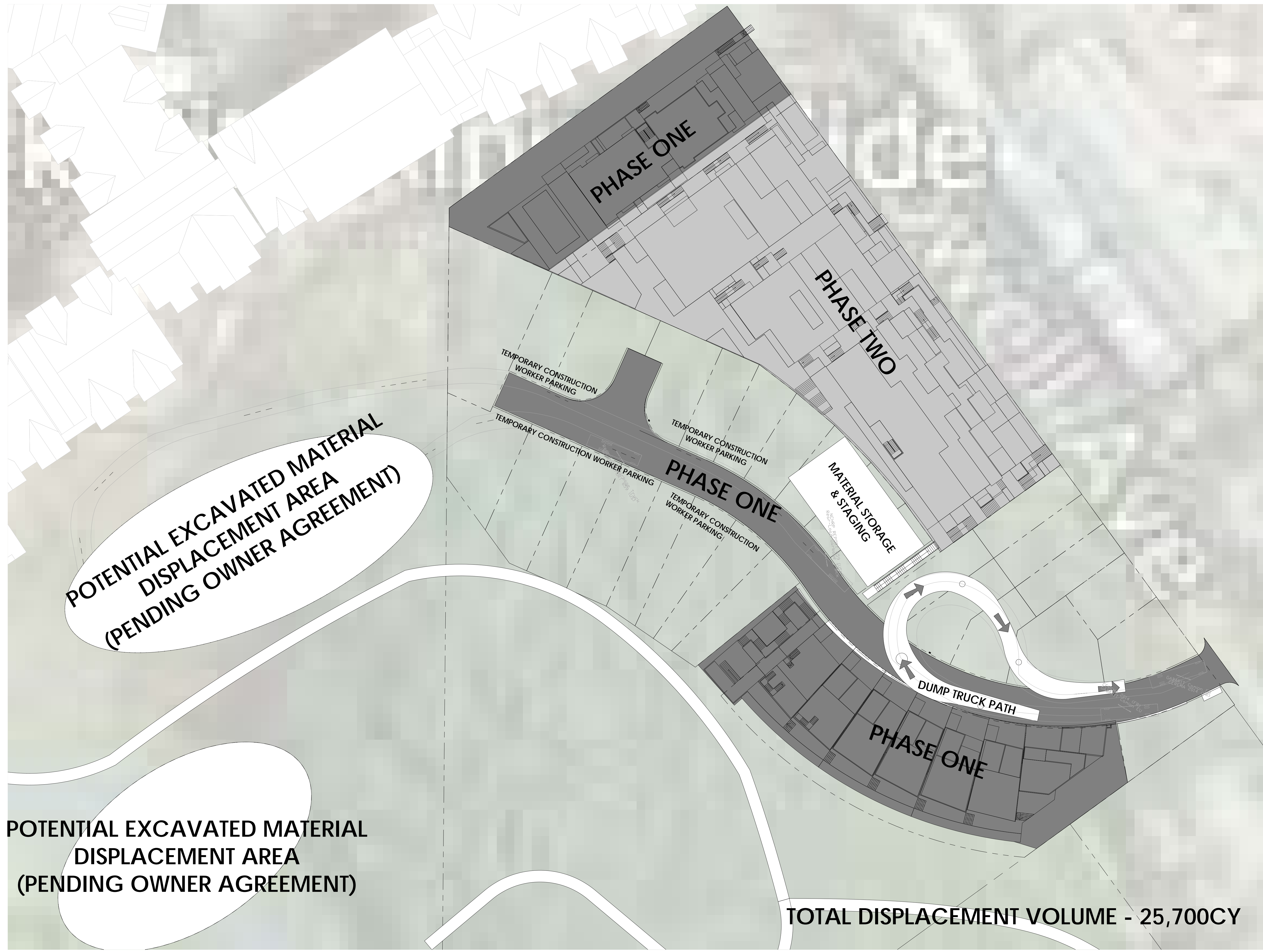

WOW

**PRELIMINARY
NOT FOR
PERMIT OR
CONSTRUCTION**

CIVIL: EVERGREEN
STRUCTURAL: JARRATT ENGINEERING
MECHANICAL: PVE INC
ELECTRICAL: BNA CONSULTING
LANDSCAPE: LO/CI
INTERIOR: WOW +

KING'S CROWN
MASTER PLANNED DEVELOPMENT
1201-1299 LOWELL AVENUE
PARK CITY, UTAH

PROJECT #: 160026
ISSUE DATE: 10/27/2017
ISSUE: IMPD SUBMITTAL REVISIONS

**CONSTRUCTION
MITIGATION**
AS-009

COPYRIGHT: WOW ateller, LLC. 2017

the concepts, ideas, drawings and specifications herein are an original unpublished work and the property of WOW Ateller, LLC and shall not be used on any other work. do not scale drawings. all conditions shall be verified on site. discrepancies shall be brought to the attention of the architect before proceeding.
plot date: 10/27/2017 1:09:32 PM



INTERNAL PEDESTRIAN CIRCULATION

AS-010

PROJECT #: 160026
ISSUE DATE: 10/27/2017
ISSUE: MPD SUBMITTAL REVISIONS

KING'S CROWN
MASTER PLANNED DEVELOPMENT
1201-1299 LOWELL AVENUE
PARK CITY, UTAH

CIVIL: EVERGREEN
STRUCTURAL: JARRATT ENGINEERING
MECHANICAL: PVE INC
ELECTRICAL: BNA CONSULTING
LANDSCAPE: LO/CI
INTERIOR: WOW +

PRELIMINARY NOT FOR PERMIT OR CONSTRUCTION

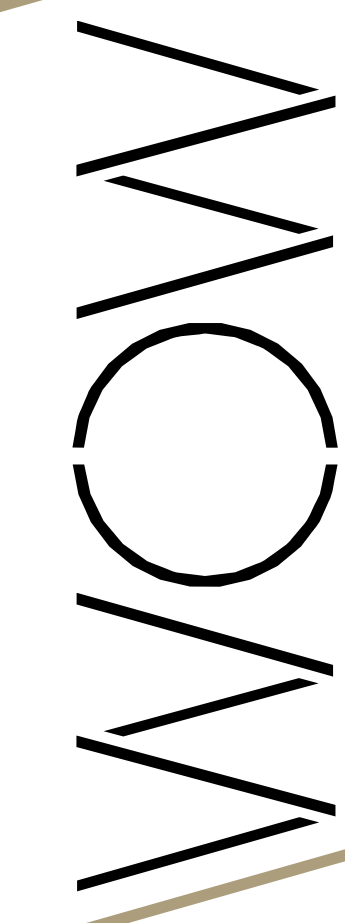

the concepts, ideas, drawings and specifications herein are an original unpublished work and the property of WOW Ateller, LLC and shall not be used on any other work. do not scale drawings. all conditions shall be verified on site, discrepancies shall be brought to the attention of the architect before proceeding.
plot date: 10/27/2017 1:09:38 PM

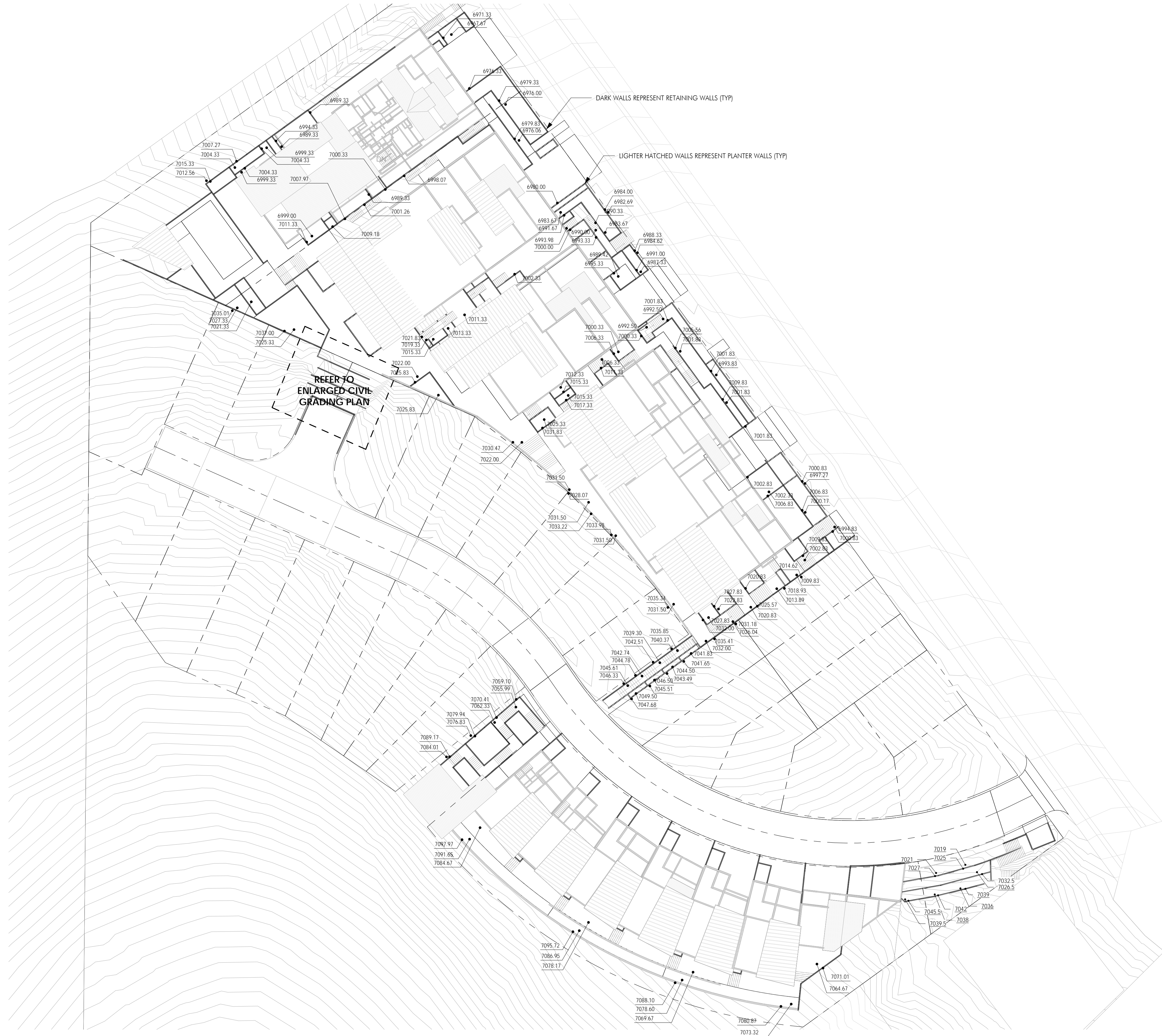

1 **RETAINING WALL & PLANTER WALL PLAN**
SCALE: 1" = 30'-0"

WOW

**PRELIMINARY
NOT FOR
PERMIT OR
CONSTRUCTION**

CIVIL: EVERGREEN
STRUCTURAL: JARRATT ENGINEERING
MECHANICAL: PVE INC
ELECTRICAL: BNA CONSULTING
LANDSCAPE: LO/CI
INTERIOR: WOW +

KING'S CROWN
MASTER PLANNED DEVELOPMENT
1201-1299 LOWELL AVENUE
PARK CITY, UTAH

PROJECT #: 160026
ISSUE DATE: 10-27-2017
ISSUE: IMPD SUBMITTAL REVISIONS

RETAINING WALL PLAN
AS-011

COPYRIGHT: WOW ateller, LLC. 2017

the concepts, ideas, drawings and specifications herein are an original unpublished work and the property of WOW Ateller, LLC and shall not be used on any other work. do not scale drawings. all conditions shall be verified on site, discrepancies shall be brought to the attention of the architect before proceeding.
plot date: 10/27/2017 3:02:17 PM



A1 ARCHITECTURAL SITE PLAN
SCALE: 1" = 30'-0"

WOW

**PRELIMINARY
NOT FOR
PERMIT OR
CONSTRUCTION**

CIVIL: EVERGREEN
STRUCTURAL: JARRATT ENGINEERING
MECHANICAL: PVE INC.
ELECTRICAL: BNA CONSULTING
LANDSCAPE: LO/CI
INTERIOR: WOW +

KING'S CROWN
MASTER PLANNED DEVELOPMENT
1201-1299 LOWELL AVENUE
PARK CITY, UTAH

PROJECT #: 160026
ISSUE DATE: 10/27/2017
ISSUE: MPD SUBMITTAL REVISIONS

ARCHITECTURAL SITE PLAN

AS-101

COPYRIGHT: WOW ateller, LLC. 2017